

11222EVSG ROTARY HAMMER

Pos.	Part Number	Description {Qty.}	F/C	Pos.	Part Number	Description {Qty.}	F/C
1	1 615 108 059	Motor Housing	71	72	1 900 210 100	O-Ring	78
2	1 614 220 111	Field 115V	22	73	1 610 210 121	O-Ring	42
5	2 610 348 734	Cord 115V 14/3	11	74	1 610 210 104	O-Ring	78
5/1	1 900 452 003	Terminal Sleeve {2}	11	75	1 610 210 105	O-Ring {2}	78
5/2	2 610 316 596	Terminal Ring	11	76	1 610 210 046	O-Ring	78
6	1 600 703 010	Strain Relief	11	77	1 610 210 106	Gasket	79
7	1 601 302 018	Cord Clamp	89	78	1 610 134 008	Plate 0.5mm	65
9	2 610 911 682	Label "11222EVSG"	9	* 78.1	1 610 134 005	Shim 0.1mm	65
10	2 610 911 635	Label "Warning"	9	* 78.2	1 610 134 006	Shim 0.2mm	65
13	2 600 905 032	Ball Bearing	60	* 78.3	1 610 134 007	Shim 0.3mm	65
14	1 900 900 289	Ball Bearing	61	79	2 600 210 003	O-Ring	78
15	1 606 610 132	Fan	23	80	1 614 634 006	Clutch Spring	67
17	1 617 233 021	Speed Control 115V	17	81	1 614 611 009	Spring	27
18	1 610 591 011	Air Deflector	24	83	1 614 611 006	Spring	27
22	1 616 317 602	Gear	32	84	1 610 101 627	Washer	65
25	1 615 805 063	Bearing Flange	38	85	1 614 601 011	Spring Ring {3}	89
26	1 618 700 063	Piston	47	86	1 614 601 012	Spring Ring {2}	89
27	1 618 710 060	Striker	44	87	1 610 390 027	Threaded Bushing {2}	82
28	1 613 124 043	Impact Bolt	45	88	1 613 200 007	Pin {3}	66
29	1 613 105 012	Wrist Pin	47	89	2 910 141 168	Screw {8}	89
33	1 610 190 016	Disc	65	91	2 910 211 036	Screw {6}	89
34	1 610 005 000	Felt	77	92	2 912 401 019	Screw {3}	89
35	1 610 206 021	Rubber Bearing Sleeve	82	93	2 910 151 164	Screw {3}	89
36	1 610 390 016	Guide Bushing	49	94	2 603 435 015	Screw {2}	89
37	1 610 390 032	Damping Bushing	49	95	2 910 091 082	Screw {2}	89
38	1 610 102 026	Washer	67	96	2 912 401 418	Screw	89
39	1 610 190 022	Clutch Disc	67	98	1 612 026 050	Switch Handle	74
40	1 613 100 019	Pin {3}	66	99	2 910 611 405	Screw {2}	89
41	1 610 101 011	Washer {2}	47	106	1 615 510 000	Light Conductor	9
42	1 610 202 015	Bushing	51	120	1 612 025 029	Auxiliary Handle	9
43	1 611 098 005	Locking Plate	65	121	1 618 040 054	Clamp Holder	80
44	1 615 820 092	Shift Fork w/pos. 45	63	122	1 613 490 002	T-Bolt	80
45	1 614 651 014	Spring Clip	63	123	1 611 316 009	Clamping Band 51mm	80
48	1 611 016 003	Holding Fork	62	124	1 613 001 008	Depth Gauge	9
49	1 612 026 035	Button	64	131	2 910 110 120	Screw	89
50	1 618 598 175	Chuck w/pos. 50/1-50/14	91	+ 132	3 601 321 001	Clamp	9
50/1	1 618 598 174	Bit Housing	40	133	3 600 150 006	Lock Washer	65
50/2	1 616 409 014	Locking Sleeve	86	720	2 602 025 077	Auxiliary Handle Assy.	9
50/3	1 614 601 016	Spring Ring	86			w/pos. 120, 121, 122, 123	
50/4	1 610 499 027	Protection Sleeve	92	803	1 614 010 160	Armature w/Fan 115V	AW
50/5	1 614 643 008	Spring	86			w/pos. 13, 14, 15, 72	
50/6	1 610 102 039	Washer	86	808	1 601 106 999	Nameplate	9
50/7	1 610 190 011	Holding Plate	86	816	1 614 336 023	Brush Holder Assembly	25
50/8	1 610 102 040	Thrust Ring	86			w/pos. 816/8-816/12	
50/9	1 610 508 026	Dust Shield	92	816/8	1 611 323 002	Contact Spring {2}	27
50/10	2 916 540 012	Spring Ring	86	816/9	1 614 652 002	Brush Spring {2}	27
50/11	1 903 230 013	Ball 7mm {5}	86	816/10	1 617 014 128	Brush Set	26
50/12	1 610 101 016	Washer	86	816/12	1 613 212 004	Rubber Buffer {2}	9
50/13	2 916 650 009	Spring Ring	86	819	1 617 000 976	Gear Cover Assembly	70
50/14	1 614 601 023	Spring Ring	86			w/pos. 43, 60, 61, 70, 96	
52	1 615 500 289	Motor Housing Cover	70	820	1 617 000 302	Gear Housing Assembly	72
53	1 616 333 028	Bevel Gear	33			w/pos. 42, 59, 65, 77, 81, 87	
54	1 616 333 029	Crown Gear	31	821	1 617 000 978	Guide Tube Assembly	43
57	1 610 390 025	Stop Bushing	49			w/pos. 39, 40, 85	
58	1 610 390 026	Guide Bushing	49	823	1 616 328 044	Gear Assembly w/pos. 63	34
59	1 610 910 080	Needle Bearing	56	824	1 613 060 021	Pinion Gear w/pos. 67	54
60	1 610 910 073	Needle Bearing	51	825	1 615 805 064	Bearing Flange Assembly	38
61	2 600 910 006	Needle Bearing	56			w/pos. 25, 33, 34, 79, 855	
62	1 610 910 074	Needle Bearing	56	830	1 615 819 022	Eccentric Cam w/pos. 62	53
63	2 600 914 010	Needle Bearing	56	832	1 612 026 037	Selector Knob Assembly	64
64	1 610 913 010	Needle Bearing	56			w/pos. 49, 76, 83	
65	1 610 920 007	Ball Bearing	56	853	1 617 000 196	Bevel Gear Assembly	33
67	1 610 905 016	Ball Bearing	56			w/pos. 14, 53, 68, 69, 72, 84	
68	1 610 119 009	Retaining Ring	89	855	1 617 000 982	Crown Gear w/pos. 54	31
69	1 610 283 024	Seal	77	897	1 617 000 980	Handle w/pos. 98, 106	74
70	1 610 283 023	Seal	77	899	1 617 000 262	Service Pack w/Grease	1
71	1 610 290 029	Scraper	49			w/pos. 34,69-77,79,85,86,816/8,816/10	

+ = Not Illustrated * = As Required F/C = Failure Code AW = Refer to AW Labor Time Chart

To: All Authorized and Factory Service Centers,
Field Sales and Internal Support Personnel

Re: Chuck Assembly Instructions for Rotary Hammers 11222EVS (06 11222 739)
 11222EVSG (06 11222 783)

Please insert this bulletin into the "Technical Bulletins" section of your Bosch Parts Manual, only after making any additions or notes to your Illustrated Parts List(s).

Following these instructions will assist your repair of the Chuck Assembly.

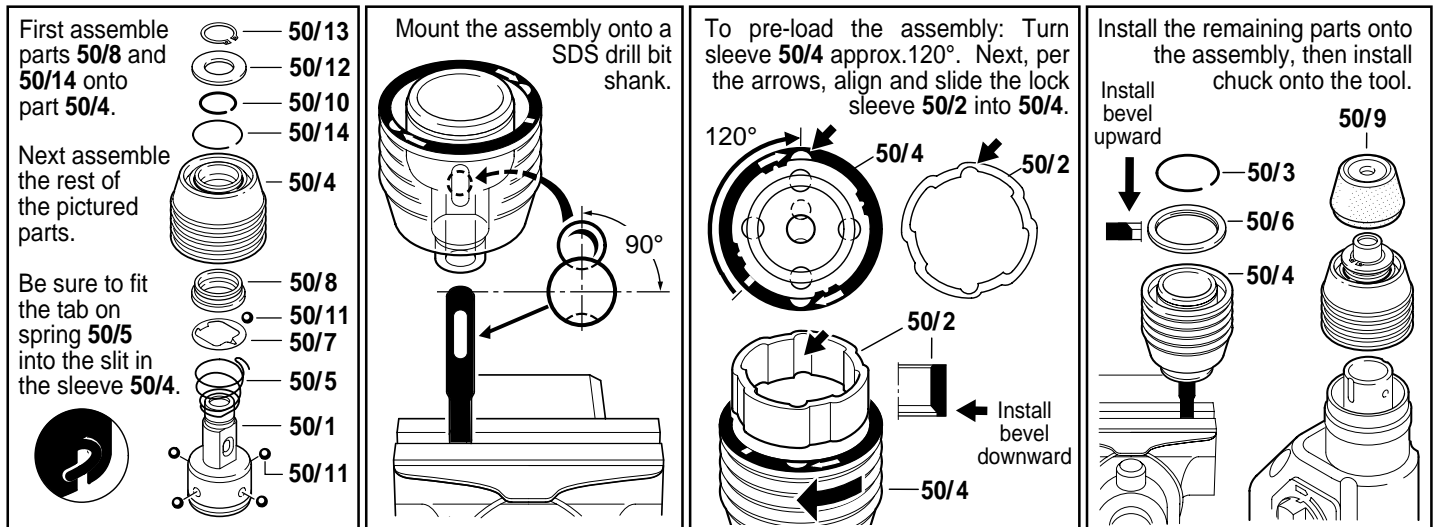

All questions should be directed to your Authorized Service Manager.

Gail D. Fred

Gail D. Fred
Product Service Department